



Safety Information and Precautions for Power Cord and AC Adapter

- Use only the Scriptel-provided AC Adapter and power cord approved for use with this device. Use of another AC adapter may cause a fire or explosion. Do not use the Scriptel-provided adapter for other products.
- Be sure that the power outlet is easily accessible and near the unit. Be sure that the cord is not located where it can be tripped over or stepped on.
- Before you connect the device to a power outlet, check the AC adapter voltage rating to ensure that the required voltage and frequency match the available power source.
- Be sure that nothing rests on your AC Adapter or the power cord.
- Insert the power cord plug fully so that no part of the prongs are exposed.
- Never damage, modify, stretch or excessively bend or twist the power cord.
- Never plug the AC adapter into a power source that is shared with other devices (extension cord, power strip, 2- or 3-way adapters, etc).
- Never use the AC adapter if the power cord is coiled, bundled or knotted.
- Never remove the plug by pulling on the end.



Scriptel Inc
4153 Arlingate Plaza
Columbus, Ohio 43228

Phone 614 276 8402
www.Scriptel.com
Fax 614 276 7615

Scriptel is a technology and product company whose offerings are based on cutting-edge, innovative, easy-to-use methods of information display and entry. Scriptel's state-of-the-art Columbus, Ohio facility houses both research and development, and production.

visigo task pad

Getting started with your Visigo task pad

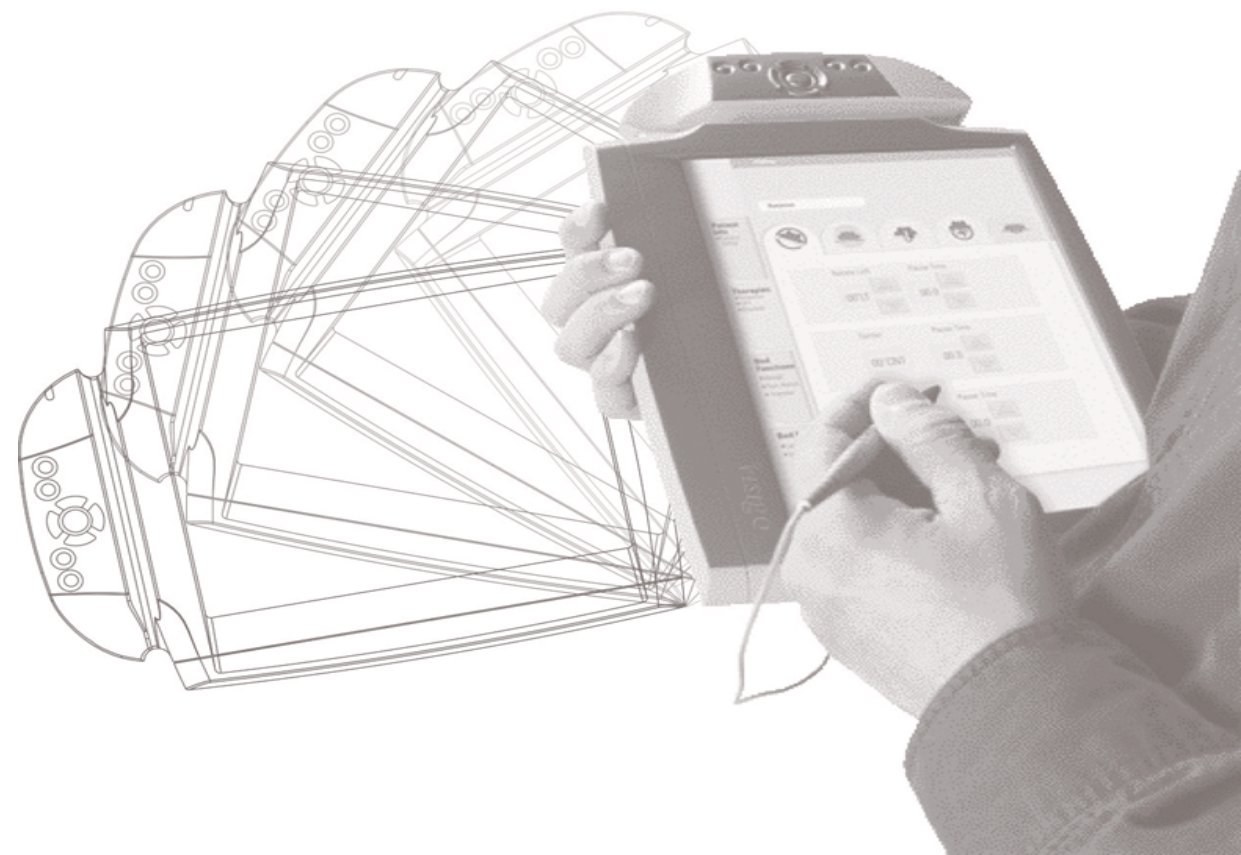

Specifications are subject to change without notice. Scriptel, VISIGO task pad are registered trademarks of the Scriptel Corporation. ©Copyright Scriptel Corporation, Patents Pending. All rights reserved.

Visigo components

Step 1
Unpack and familiarize yourself with the Visigo task pad components and controls.

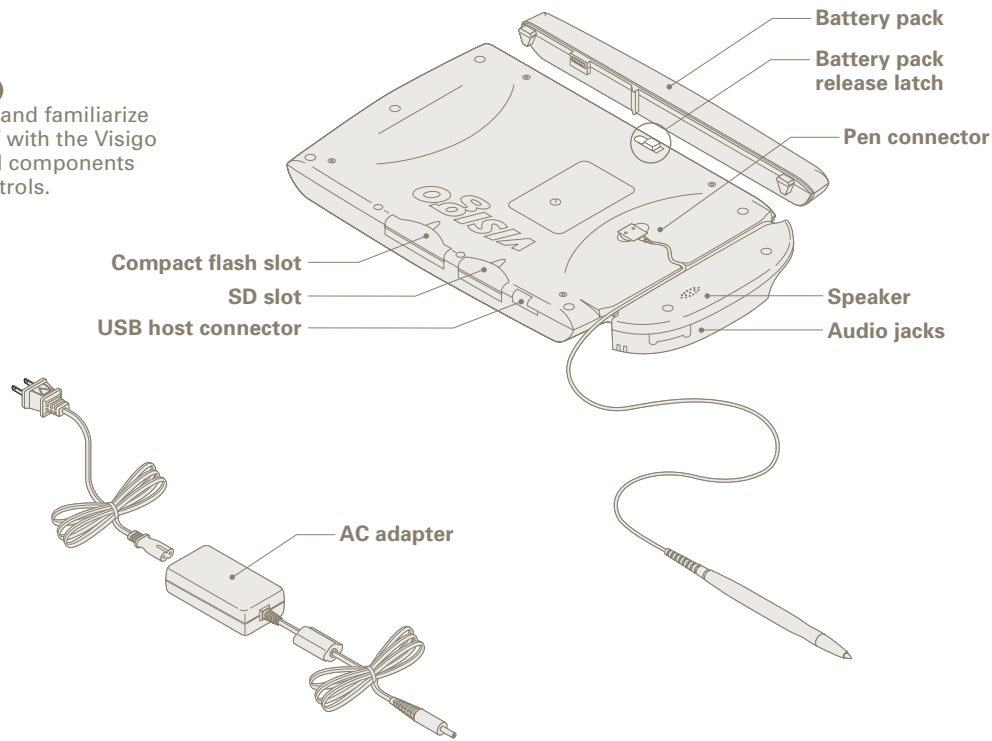

Understanding Visigo controls

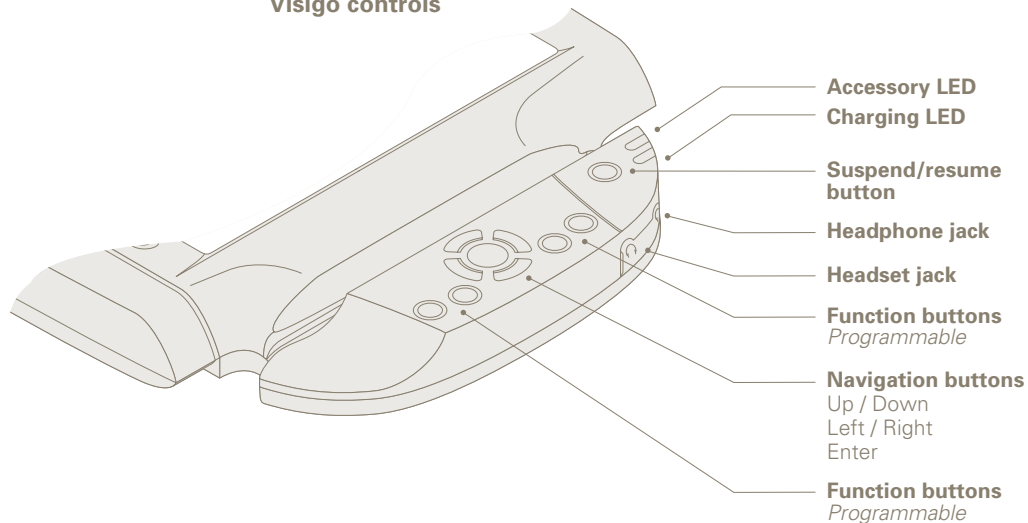

Connecting and charging the battery

Step 2
Connect the **Battery pack** to the Visigo task pad by sliding it into the keyed open slot at the bottom of the unit.

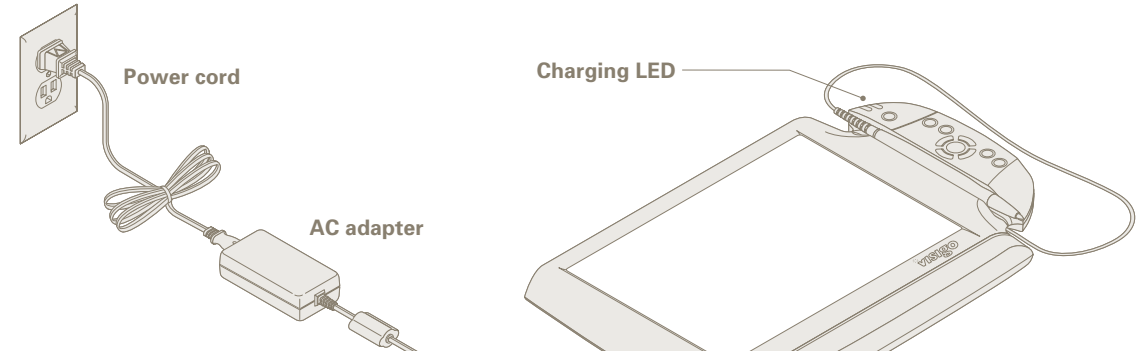
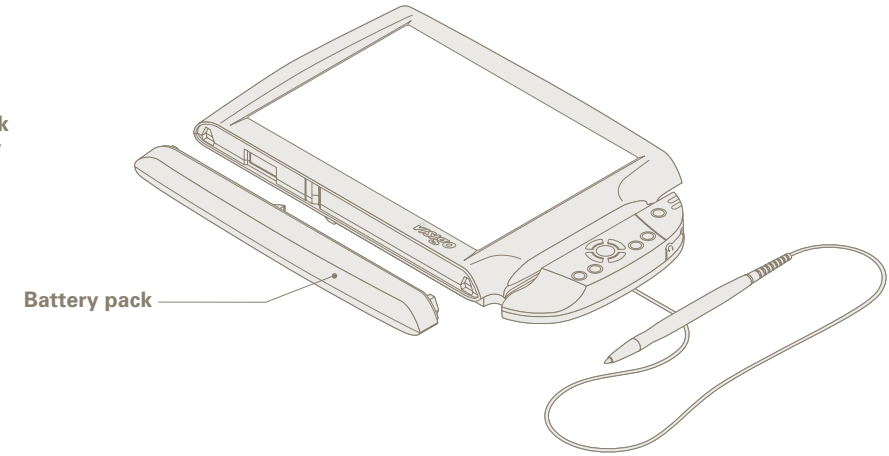

Step 3
Connect **Power cord** to **AC adapter**.

Connect **AC adapter** to Visigo task pad.

Connect the **Power cord** to a working electrical outlet. Charge the battery for 14 hours before using the unit for the first time.

Caution: Failure to charge battery for 14 hours before using Visigo task pad may adversely affect the long term battery life.

